



An agency of the Government of Ontario



Un organisme du gouvernement de l'Ontario

This document was retrieved from the Ontario Heritage Act Register, which is accessible through the website of the Ontario Heritage Trust at **[www.heritagetrust.on.ca](http://www.heritagetrust.on.ca)**.

---

Ce document est tiré du registre aux fins de la *Loi sur le patrimoine de l'Ontario*, accessible à partir du site Web de la Fiducie du patrimoine ontarien sur **[www.heritagetrust.on.ca](http://www.heritagetrust.on.ca)**.

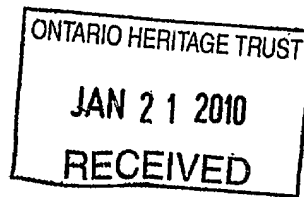

January 20, 2010

Ontario Heritage Trust  
10 Adelaide street East  
Toronto, ON M5C 1J3

Incumbent and Warden of Services Branch  
Luke's Church Palermo  
252 James Street, Hamilton ON  
L8R 2L3

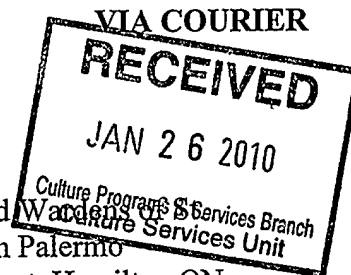

Dear Sirs and/or Madames:

**Subject: Notice of Heritage Designation**  
**3114 Dundas Street West, Oakville, Ontario**

---

Attached please find the Notice of Heritage Designation together with By-law 2010-020 with respect to the heritage designation of 3114 Dundas Street West, Oakville, Ontario which is served upon you in accordance with section 29(6) of the *Ontario Heritage Act*, R.S.O. 1990, c.18.

Sincerely,

Francesca Piazza  
Legislative Coordinator

Encls.

c.c. C. Best, Town Clerk  
D. Anderson, Director of Planning Services  
D. Baker, Assistant Town Solicitor  
M. Seaman, Manager of Heritage Planning



OAKVILLE

THE CORPORATION OF THE TOWN OF OAKVILLE

BY-LAW NUMBER 2010-020

A by-law to designate the St. Luke's Anglican Church at Palermo at 3114 Dundas Street West as a property of historical, architectural and/or contextual significance.

**WHEREAS** pursuant to Part IV of the *Ontario Heritage Act*, R.S.O. 1990, Chapter O.18, the Council of a municipality is authorized to enact by-laws to designate a real property, including all buildings and structures thereon, to be of cultural heritage value or interest;

**WHEREAS** the municipal council of the Corporation of the Town of Oakville has cause to be served on the owners of the lands and premises at:

3114 Dundas Street West  
Oakville, ON

and upon the Ontario Heritage Trust, notice of intention to designate **St. Luke's Anglican Church at Palermo at 3114 Dundas Street West** and a statement of the reasons for the proposed designation, and further, has caused said notice of intention to be published in the Oakville Beaver, being a newspaper of general circulation in the municipality;

**AND WHEREAS** no notice of objection to the proposed designation has been served on the municipality;

**AND WHEREAS** the reasons for designation are set out in Schedule "B" attached hereto and form part of this By-law;

**COUNCIL ENACTS AS FOLLOWS:**

1. THAT the following real property, more particularly described in Schedule "A" attached hereto and forming part of this By-law is hereby designated as being of cultural heritage value or interest:

St. Luke's Anglican Church at Palermo  
3114 Dundas Street West  
Town of Oakville  
The Regional Municipality of Halton



OAKVILLE

By-Law Number: 2010-020

- 
2. THAT the Town solicitor is hereby authorized to cause a copy of this By-law to be registered against the property described in Schedule "A" attached hereto at the Land Registry Office.

PASSED this 11th day of January, 2010.

Rob Burton

MAYOR

Vicki Tytaneck

A/CLERK

---

## SCHEDULE "A" TO BY-LAW 2010-020

In the Town of Oakville in the Regional Municipality of Halton, property description as follows:

St. Luke's Anglican Church at Palermo,  
3114 Dundas Street West, PT LT 32, CON 1 TRAF SDS, AS IN  
TW776, EXCEPT PT 2, 20R15842; OAKVILLE  
Town of Oakville, Regional Municipality of Halton

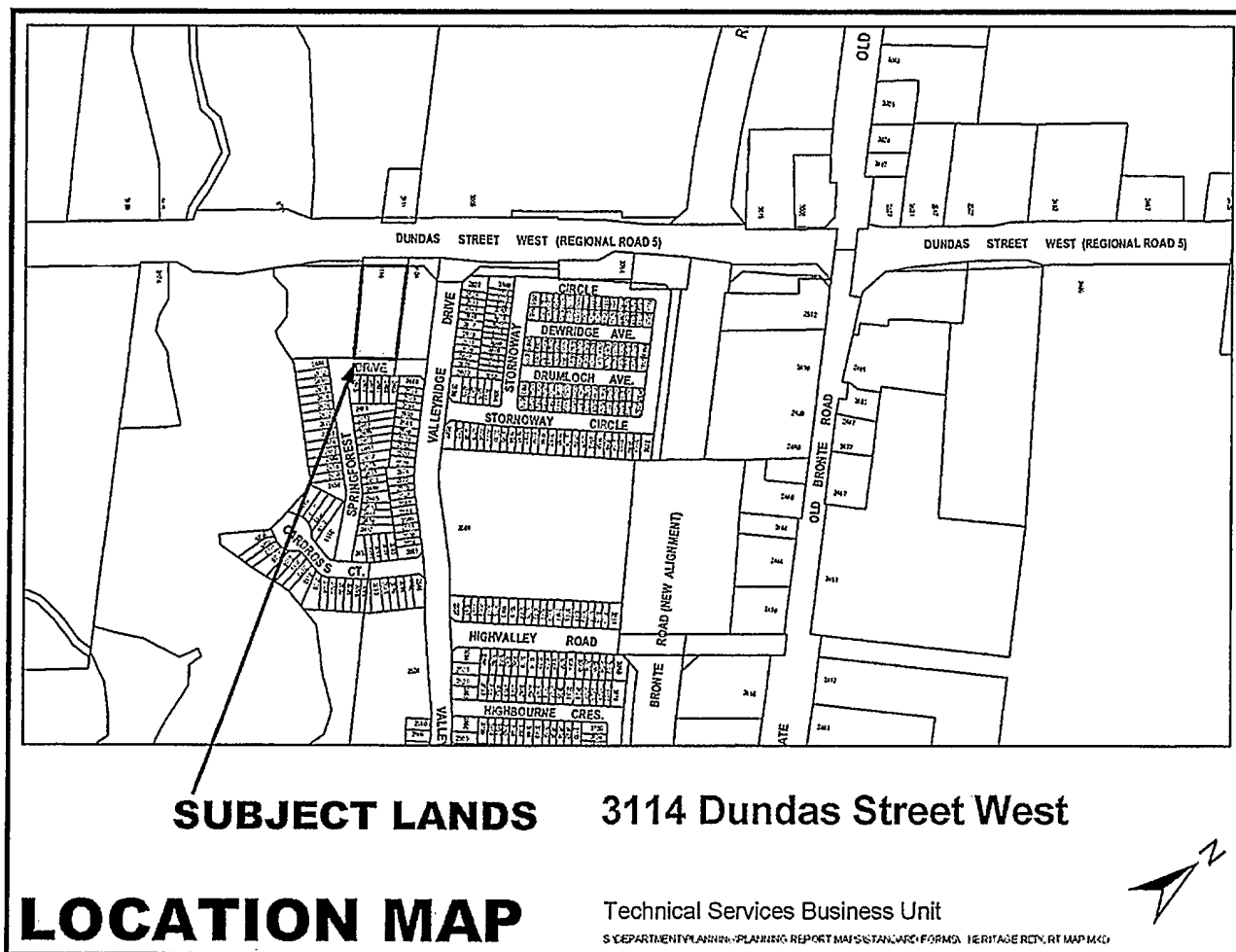

---

**SCHEDULE "B" TO  
BY-LAW 2010-020**

**STATEMENT OF SIGNIFICANCE**

Description of Property

The property at 3114 Dundas Street West is located on the south side of Dundas Street west of Bronte Road, in the Town of Oakville. It includes one church building, currently used by St. Luke's Anglican Church at Palermo.

Statement of Cultural Heritage Value

*Design or Physical Value*

St. Luke's Anglican Church at Palermo has cultural heritage value as an excellent rare, representative and early rural example of an ecclesiastical building constructed in a vernacular expression of the Regency Gothic Revival style.

The building is the only remaining historic wood church in what was historically rural Oakville and one of two remaining historic wood churches in the whole of Oakville, along with St. Andrew's Catholic Church.

The Gothic Revival style was first implemented for churches in Canada in the Maritimes in the late 18<sup>th</sup> century. The style became prevalent in Ontario in the 1820s with many Anglican churches being constructed in the style by the 1840s.

St. Luke's Church is an example of Regency Gothic style because of the fanciful web-like windows, some of which have since been replaced. The Regency style of the early to mid 19<sup>th</sup> century reflects a romantic interest in ancient, exotic and picturesque styles.

While most of the remaining Gothic Revival churches in Ontario were constructed of stone, the Canadian climate and availability and abundance of lumber often required the use of wood in the early 19<sup>th</sup> century. St. Luke's Church was built of timber frame construction with heavy timbers jointed together with wooden pegs rather than nails. Horizontal clapboard was installed over this timber framing, which likely remains underneath the modern vinyl siding.

Churches like St. Luke's which are built in the Gothic Revival style and constructed of wood are often described as Carpenter Gothic style. Many of Ontario's early churches were of frame construction, but few of these wood structures have survived; some were destroyed by fire or succumbed to neglect, or were replaced by stone or brick structures.

---



Outstanding physical design elements of the Gothic Revival style of St. Luke's Church include the 3-bay symmetrical design, the pointed arched windows, doors and hood moulding and the pitch of the gable roof. Unique to this particular example is the form of the gable roof, including the two pinnacles on the front façade and the belfry, which is not original to the building. Wood cladding, covered by vinyl siding, may also exist and contribute to the vernacular expression of the church's Gothic Revival style.

Several changes have been made to the property since its 19<sup>th</sup> century construction. The belfry was constructed in 1932, with the bell from the former Palermo foundry installed in the belfry. In 1951, the church was raised and a new basement constructed, which is commemorated through the datestone on the northwest corner of the church which reads: "St. Luke's Church 1845-1951".

The subject building also has excellent physical value by virtue of its date of construction. It is one of the oldest buildings in Palermo and one of the earliest remaining churches in Oakville and in Halton Region, having been constructed in 1845. A wooden datestone on the front façade which reads "1845" commemorates this construction date.

The cemetery, located at the rear of the church also has physical design value in the varying styles and materials of the monuments and headstones. It is a good example of 19<sup>th</sup> century small cemetery design, and is representative of small churchyard cemeteries.

Also a structure of heritage value is the stone cairn, located in the northwest corner of the church property. It was constructed in 1945 of local field stones set in mortar and includes a plaque that reads:

*1845-1945/ THIS CAIRN IS ERECTED TO COMMEMORATE THE  
CENTENNIAL OF ST. LUKE'S CHURCH AND TO HONOUR THE  
MEMORY OF THE PIONEERS WHO FOUNDED IT.*

#### *Historical or Associative Value*

St. Luke's Anglican Church at Palermo has strong cultural heritage value for its historical association with the village of Palermo, which developed in the early 1800s as Dundas Street became a major roadway. Significant past residents of the Palermo community have been members at St. Luke's, including Harvey M. Switzer (b.1819), local businessman, postmaster, and politician.

The subject property also has excellent heritage value for its association with William Peacock, an early and prominent settler in Palermo Village. Peacock was an English sea captain who retired with his family to Upper Canada in 1832. Peacock served as



tax collector, then first Justice of the Peace for Halton, and also established the local land registry office.

A staunch Anglican, Peacock held prayer services in his home from c.1835, as there was no Anglican church in the vicinity. The growing number of settlers demanded the construction of a church, and in 1845, John Englehart donated a parcel of land a quarter mile west of Palermo Village. Peacock, who was also an experienced cabinet-maker, designed and supervised the building of the church, which was constructed of wood cleared from the property.

The first service of worship took place on March 1, 1845. However, the church was not officially consecrated until 1868 when the debt of construction had been paid off. Attendance declined at the turn of the century and the church was closed for several years, but re-opened in 1908. The church has been in continuous service since then.

The churchyard cemetery also has distinct historical value through its associations with the early settlers buried in the grounds. Grave markers date back to at least 1814, decades before the construction of the church. William Peacock and his wife, Harriet, were both buried in the cemetery behind the church, as were many other early settlers in Trafalgar Township.

The stone cairn was constructed in 1945 to celebrate the centennial of St. Luke's Church. Built by parishioners James Fairbrother and George Atkins, the cairn was constructed of stones brought in by local farmers.

St. Luke's Anglican Church at Palermo also has strong historical value through its association with the Church of England and the Anglican Church of Canada. This Protestant denomination was brought to the area by English and Loyalist settlers who held private services at home and went on to build churches to continue worshipping in the traditions of the Church of England. The Anglican Church of Canada remains the third largest church in Canada today.

#### *Contextual Value*

As part of the historic village of Palermo, St. Luke's Anglican Church at Palermo is contextually significant as a landmark within the village and along Dundas Street. The building is a reminder of the importance of the church in early Ontario settlements. The growth of the village of Palermo was assisted by the construction of this church which gave residents a home for spiritual and community activities. The location of the church along the main thoroughfare of Dundas Street gave travellers the opportunity to attend service while on the road. The churchyard cemetery provided consecrated ground near the village to allow for local burials.

The village of Palermo is extremely significant as the oldest remaining urban centre in the Town of Oakville and as one of the Town's only remaining villages, along with Oakville and Bronte. Settlement began in Palermo over 200 years ago in 1806,

---



some 20 years prior to the founding of settlements at the ports of Bronte and Oakville. The village thrived in the early to mid-19<sup>th</sup> century as a result of its position along Dundas Street, which was the oldest and most significant east-west overland route between Toronto and western Ontario for more than a century. It was also strategically situated midway along the north-south road between Bronte and Milton.

At its peak around 1920, Palermo boasted as many as 30 houses, a community hall, a school, an implements factory, a sawmill, two churches, two general stores, a park and an implements store. Such was the prominence of the village that it could boast the introduction of sidewalks, prior to the installation of sidewalks in Oakville.

With the widening of Dundas Street West and the recent construction of the Bronte Road by-pass, the historic fabric that makes up Palermo's streetscape has been challenged, yet significant elements of the village remain. St. Luke's Anglican Church at Palermo is one of the remaining historic buildings in the village and as an ecclesiastical building has the potential to continue to effectively define and support the hamlet character of Palermo.

---

### Description of Heritage Attributes

#### 1) Church

Key exterior attributes of the church which embody its physical and historical significance include:

The following heritage attributes which apply to all elevations and the roof of the church including all facades, entrances, windows and trim, together with construction materials of wood and glazing, and their related building techniques:

- Exterior plan of the church which is composed of the large rectangular sanctuary and the chancel extended from the sanctuary at the rear;
- Exterior form of the gable roof, including the belfry and two pinnacles on the front façade;
- Timber-frame construction and any surviving and intact historic wood cladding and features;
- The arrangement of the fenestration;
- The stained glass window on the south elevation of the chancel;
- The stained glass window located on the south end of the west elevation, depicting the Queen Victoria Jubilee;
- Wood hood moulds above the two windows on the front façade and above the window on the north elevation of the chancel;
- Exterior front wood door and its corresponding wood trim and hood mould;
- Date marker on front façade which reads "1845"; and
- Date marker on southwest corner which reads "St. Luke's Church 1845-1951".

Key attributes of the church which contribute to its contextual significance include:

- Its proximity to Dundas Street, one of the first major inland transportation routes to be built in Upper Canada.

#### 2) Cemetery

Key exterior attributes of the cemetery which embody its physical and historical significance include:

- Its original markers and monuments;
- The variety of styles, materials and symbolism represented in the markers and monuments ; and
- The range of size and sophistication of markers and monuments, from modest to elaborate.



3) Cairn

Key exterior attributes of the cairn which embody its physical and historical significance include:

- The stones;
- The general pyramid-like form of the cairn; and
- The plaque.



OAKVILLE

By-Law Number: 2010-020

---

### **Explanatory Note**

Re: Heritage Designation By-law No. 2010-020

By-law Number 2010-020 the following purpose and effect:

To designate the property at 3114 Dundas Street West as a property of cultural heritage value or interest pursuant to the provisions of the *Ontario Heritage Act*, R.S.O., 1990, Chapter O.18, Part IV, Section 29.

---



## **NOTICE OF HERITAGE DESIGNATION**

**St. Luke's Anglican Church  
3114 Dundas Street West, Oakville, Ontario**

**TAKE NOTICE** that Oakville Town Council, on **January 11, 2010** resolved to pass By-law **2010-020** to designate **PT LT 32, CON 1 TRAF SDS, AS IN TW776, EXCEPT PT 2, 20R15842; OAKVILLE** municipally known as **3114 Dundas Street West** under Section 29 of the *Ontario Heritage Act*, R.S.O. 1990, c. 18, as a property of cultural heritage value and interest.

### **Cultural Heritage Value and Interest:**

#### **Design or physical value**

St. Luke's Anglican Church at Palermo has cultural heritage value as an excellent rare, representative and early rural example of an ecclesiastical building constructed in a vernacular expression of the Regency Gothic Revival style.

The building is the only remaining historic wood church in what was historically rural Oakville and one of two remaining historic wood churches in the whole of Oakville, along with St. Andrew's Catholic Church.

The Gothic Revival style was first implemented for churches in Canada in the Maritimes in the late 18<sup>th</sup> century. The style became prevalent in Ontario in the 1820s with many Anglican churches being constructed in the style by the 1840s.

St. Luke's Church is an example of Regency Gothic style because of the fanciful web-like windows, some of which have since been replaced. The Regency style of the early to mid 19<sup>th</sup> century reflects a romantic interest in ancient, exotic and picturesque styles.

While most of the remaining Gothic Revival churches in Ontario were constructed of stone, the Canadian climate and availability and abundance of lumber often required the use of wood in the early 19<sup>th</sup> century. St. Luke's Church was built of timber frame construction with heavy timbers jointed together with wooden pegs rather than nails. Horizontal clapboard was installed over this timber framing, which likely remains underneath the modern vinyl siding.

Churches like St. Luke's which are built in the Gothic Revival style and constructed of wood are often described as Carpenter Gothic style. Many of Ontario's early churches were of frame construction, but few of these wood structures have survived; some were destroyed by fire or succumbed to neglect, or were replaced by stone or brick structures.

Outstanding physical design elements of the Gothic Revival style of St. Luke's Church include the 3-bay symmetrical design, the pointed arched windows, doors and hood moulding and the pitch of the gable roof. Unique to this particular example is the form of the gable roof, including the two pinnacles on the front façade and the belfry, which is not original to the building. Wood cladding, covered by vinyl siding, may also exist and contribute to the vernacular expression of the church's Gothic Revival style.

Several changes have been made to the property since its 19<sup>th</sup> century construction. The belfry was constructed in 1932, with the bell from the former Palermo foundry installed in the belfry. In 1951, the church was raised and a new basement constructed, which is commemorated through the datestone on the northwest corner of the church which reads: "St. Luke's Church 1845-1951".

The subject building also has excellent physical value by virtue of its date of construction. It is one of the oldest buildings in Palermo and one of the earliest remaining churches in Oakville and in Halton Region, having been constructed in 1845. A wooden datestone on the front façade which reads "1845" commemorates this construction date.

The cemetery, located at the rear of the church also has physical design value in the varying styles and materials of the monuments and headstones. It is a good example of 19<sup>th</sup> century small cemetery design, and is representative of small churchyard cemeteries.

Also a structure of heritage value is the stone cairn, located in the northwest corner of the church property. It was constructed in 1945 of local field stones set in mortar and includes a plaque that reads:

*1845-1945/ THIS CAIRN IS ERECTED TO COMMEMORATE THE CENTENNIAL  
OF ST. LUKE'S CHURCH AND TO HONOUR THE MEMORY OF THE PIONEERS  
WHO FOUNDED IT.*

#### **Historical or associative value**

St. Luke's Anglican Church at Palermo has strong cultural heritage value for its historical association with the village of Palermo, which developed in the early 1800s as Dundas Street became a major roadway. Significant past residents of the Palermo community have been members at St. Luke's, including Harvey M. Switzer (b.1819), local businessman, postmaster, and politician.

The subject property also has excellent heritage value for its association with William Peacock, an early and prominent settler in Palermo Village. Peacock was an English sea captain who retired with his family to Upper Canada in 1832. Peacock served as tax collector, then first Justice of the Peace for Halton, and also established the local land registry office.

A staunch Anglican, Peacock held prayer services in his home from c.1835, as there was no Anglican church in the vicinity. The growing number of settlers demanded the construction of a church, and in 1845, John Englehart donated a parcel of land a quarter mile west of Palermo Village. Peacock, who was also an experienced cabinet-maker, designed and supervised the building of the church, which was constructed of wood cleared from the property.

The first service of worship took place on March 1, 1845. However, the church was not officially consecrated until 1868 when the debt of construction had been paid off. Attendance declined at the turn of the century and the church was closed for several years, but re-opened in 1908. The church has been in continuous service since then.

The churchyard cemetery also has distinct historical value through its associations with the early settlers buried in the grounds. Grave markers date back to at least 1814, decades before the construction of the church. William Peacock and his wife, Harriet, were both buried in the cemetery behind the church, as were many other early settlers in Trafalgar Township.

The stone cairn was constructed in 1945 to celebrate the centennial of St. Luke's Church. Built by parishioners James Fairbrother and George Atkins, the cairn was constructed of stones brought in by local farmers.

St. Luke's Anglican Church at Palermo also has strong historical value through its association with the Church of England and the Anglican Church of Canada. This Protestant denomination was brought to the area by English and Loyalist settlers who held private services at home and went on to build churches to continue worshipping in the traditions of the Church of England. The Anglican Church of Canada remains the third largest church in Canada today.

### **Contextual value**

As part of the historic village of Palermo, St. Luke's Anglican Church at Palermo is contextually significant as a landmark within the village and along Dundas Street. The building is a reminder of the importance of the church in early Ontario settlements. The growth of the village of Palermo was assisted by the construction of this church which gave residents a home for spiritual and community activities. The location of the church along the main thoroughfare of Dundas Street gave travellers the opportunity to attend service while on the road. The churchyard cemetery provided consecrated ground near the village to allow for local burials.

The village of Palermo is extremely significant as the oldest remaining urban centre in the Town of Oakville and as one of the Town's only remaining villages, along with Oakville and Bronte. Settlement began in Palermo over 200 years ago in 1806, some 20 years prior to the founding of settlements at the ports of Bronte and Oakville. The village thrived in the early to mid-19<sup>th</sup> century as a result of its position along Dundas Street, which was the oldest and most significant east-west overland route between Toronto and western Ontario for more than a century. It was also strategically situated midway along the north-south road between Bronte and Milton.

At its peak around 1920, Palermo boasted as many as 30 houses, a community hall, a school, an implements factory, a sawmill, two churches, two general stores, a park and an implements store. Such was the prominence of the village that it could boast the introduction of sidewalks, prior to the installation of sidewalks in Oakville.

With the widening of Dundas Street West and the recent construction of the Bronte Road by-pass, the historic fabric that makes up Palermo's streetscape has been challenged, yet significant elements of the village remain. St. Luke's Anglican Church at Palermo is one of the remaining historic buildings in the village and as an ecclesiastical building has the potential to continue to effectively define and support the hamlet character of Palermo.

### **Description of Heritage Attributes:**

#### **1) Church**

Key exterior attributes of the church which embody its physical and historical significance include:

The following heritage attributes which apply to all elevations and the roof of the church including all facades, entrances, windows and trim, together with construction materials of wood and glazing, and their related building techniques:

- Exterior plan of the church which is composed of the large rectangular sanctuary and the chancel extended from the sanctuary at the rear;
- Exterior form of the gable roof, including the belfry and two pinnacles on the front façade;
- Timber-frame construction and any surviving and intact historic wood cladding and features;
- The arrangement of the fenestration;

- The stained glass window on the south elevation of the chancel;
- The stained glass window located on the south end of the west elevation, depicting the Queen Victoria Jubilee;
- Wood hood moulds above the two windows on the front façade and above the window on the north elevation of the chancel;
- Exterior front wood door and its corresponding wood trim and hood mould;
- Date marker on front façade which reads "1845"; and
- Date marker on southwest corner which reads "St. Luke's Church 1845-1951".

Key attributes of the church which contribute to its contextual significance include:

- Its proximity to Dundas Street, one of the first major inland transportation routes to be built in Upper Canada.

## 2) Cemetery

Key exterior attributes of the cemetery which embody its physical and historical significance include:

- Its original markers and monuments;
- The variety of styles, materials and symbolism represented in the markers and monuments ; and
- The range of size and sophistication of markers and monuments, from modest to elaborate.

## 3) Cairn

Key exterior attributes of the cairn which embody its physical and historical significance include:

- The stones;
- The general pyramid-like form of the cairn; and
- The plaque.

**MORE INFORMATION:** Any inquiries may be directed to Michael Seaman, Manager of Heritage Planning at 905-845-6601, extension 3875 or by email at [mseaman@oakville.ca](mailto:mseaman@oakville.ca)

**Cathie Best, Town Clerk**