

RECTANGULAR HALL WITH GABLE ROOF

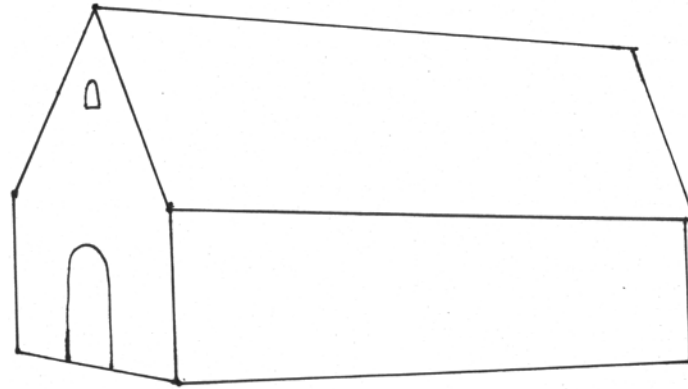

1



3



2

One of the simplest massing types, this one features a gable roof on a rectangular floor plan, which is common in pioneer, first-generation Christian churches in Ontario, such as the simple log cabin. The type sometimes evolved into a different massing type with the addition of towers. This massing type became popular again in the 20th century with the rise of Modernism and A-frame buildings. Examples: 1. African Methodist Episcopal Church (Oro-Medonte), 2. St. Margaret in the Pines Anglican Church (Toronto), 3. Ste- Thérèse-de-l'Enfant-Jésus Roman Catholic Church (Temiskaming Shores), 4. Yorkminster Citadel Salvation Army Church (Toronto)



4